

ESECUTIVO - QUOTA 0,0

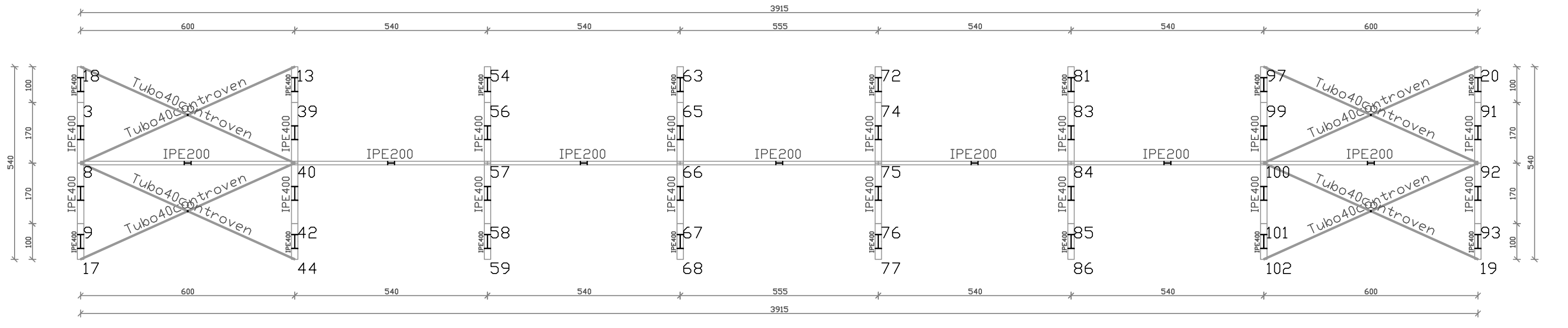

ESECUTIVO - QUOTA 11,20

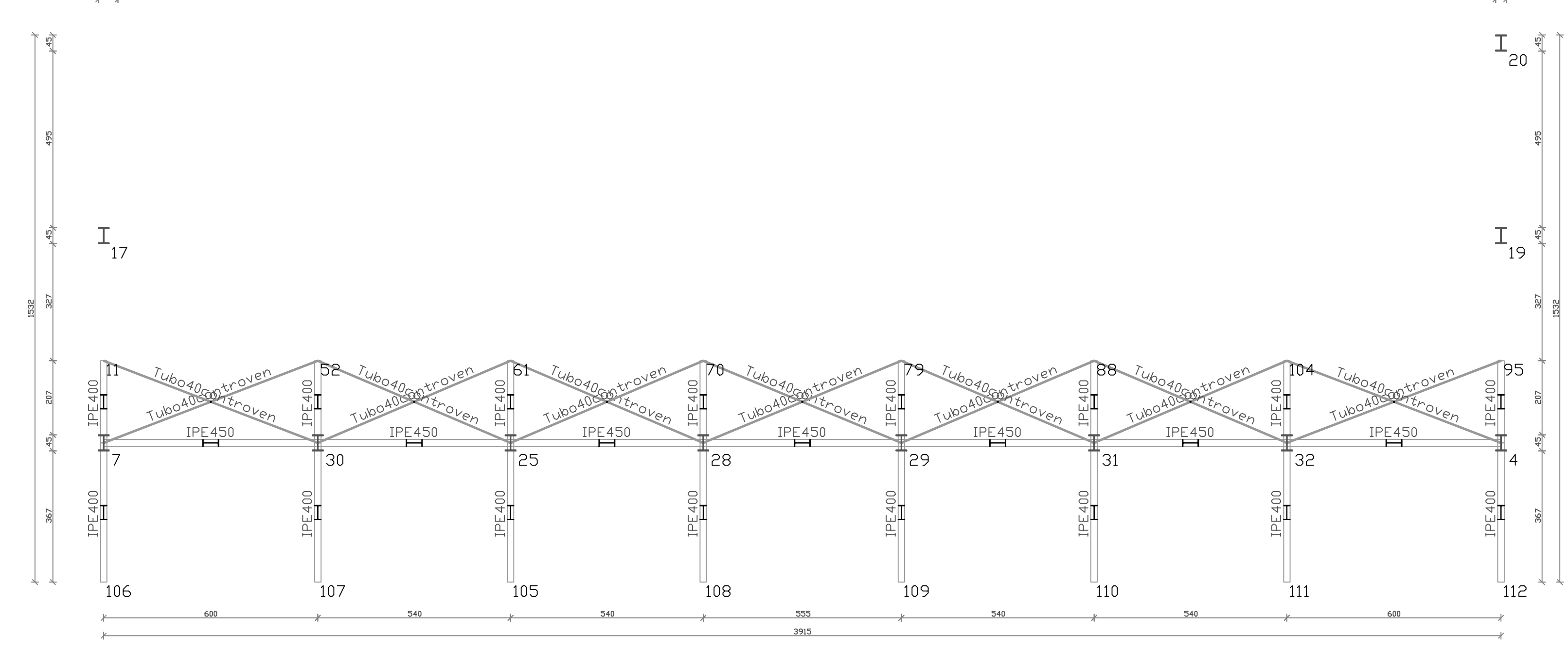

ESECUTIVO - QUOTA 8,50

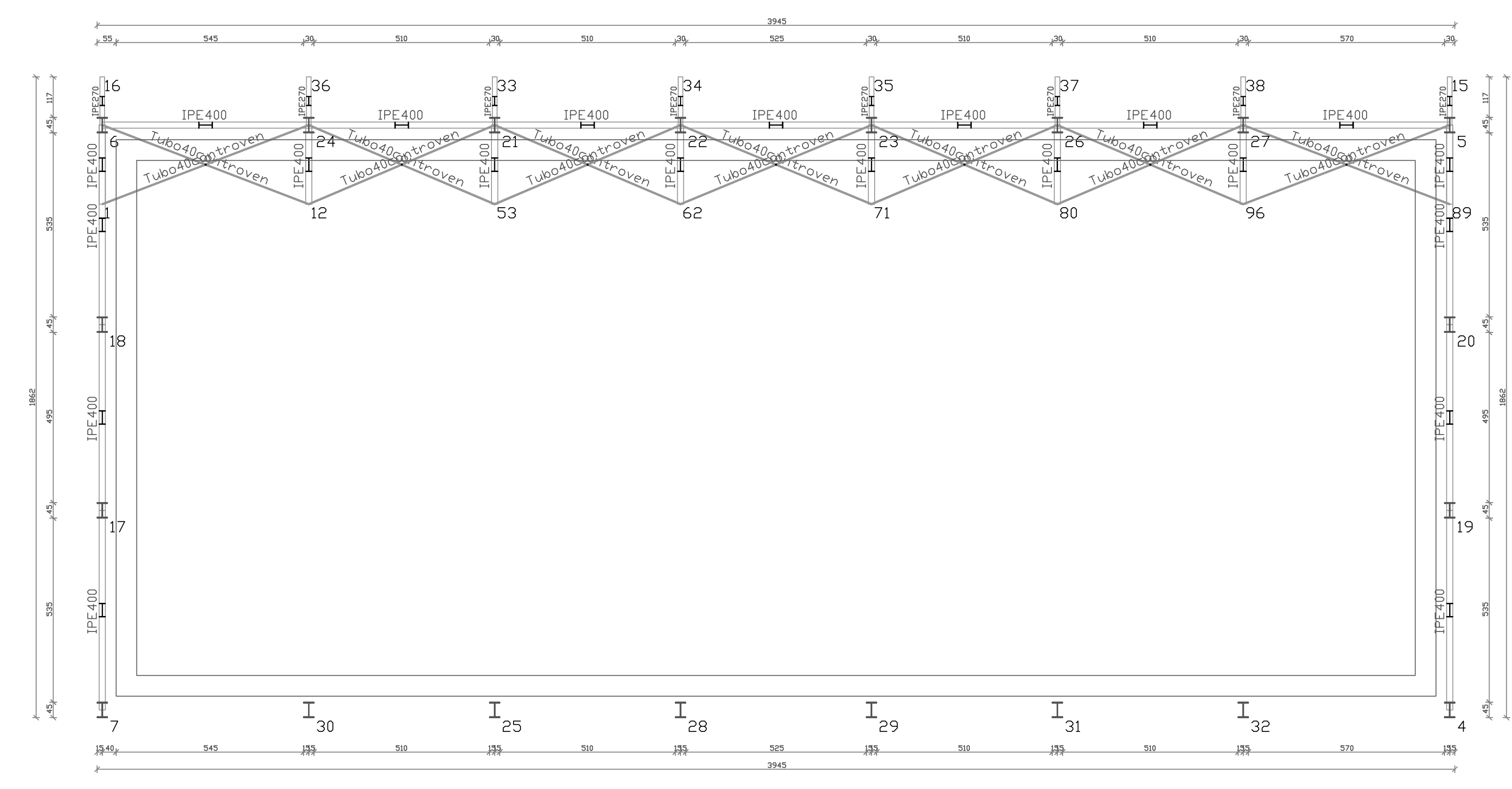

ESECUTIVO - QUOTA 6,7

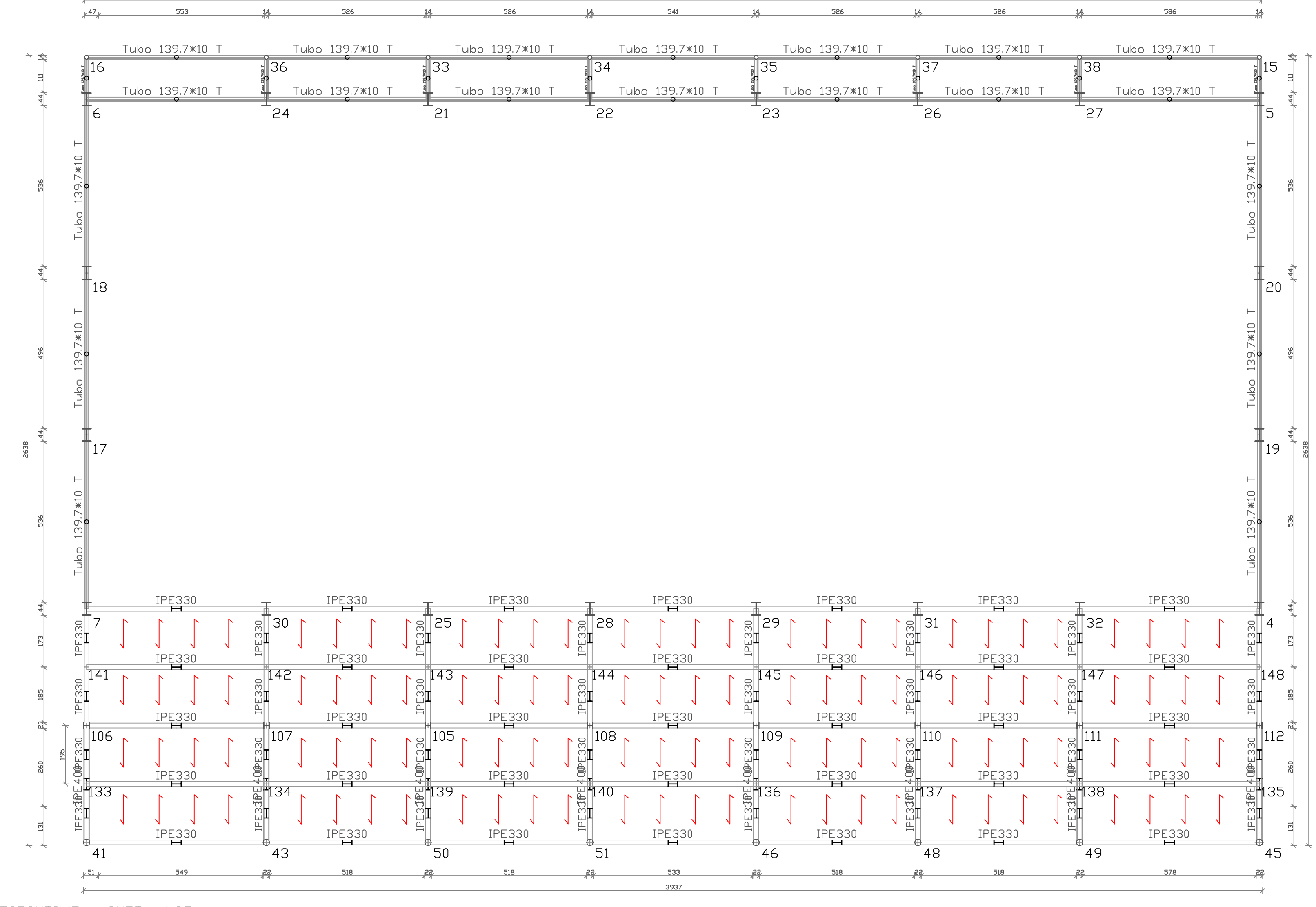

ESECUTIVO - QUOTA 4,25

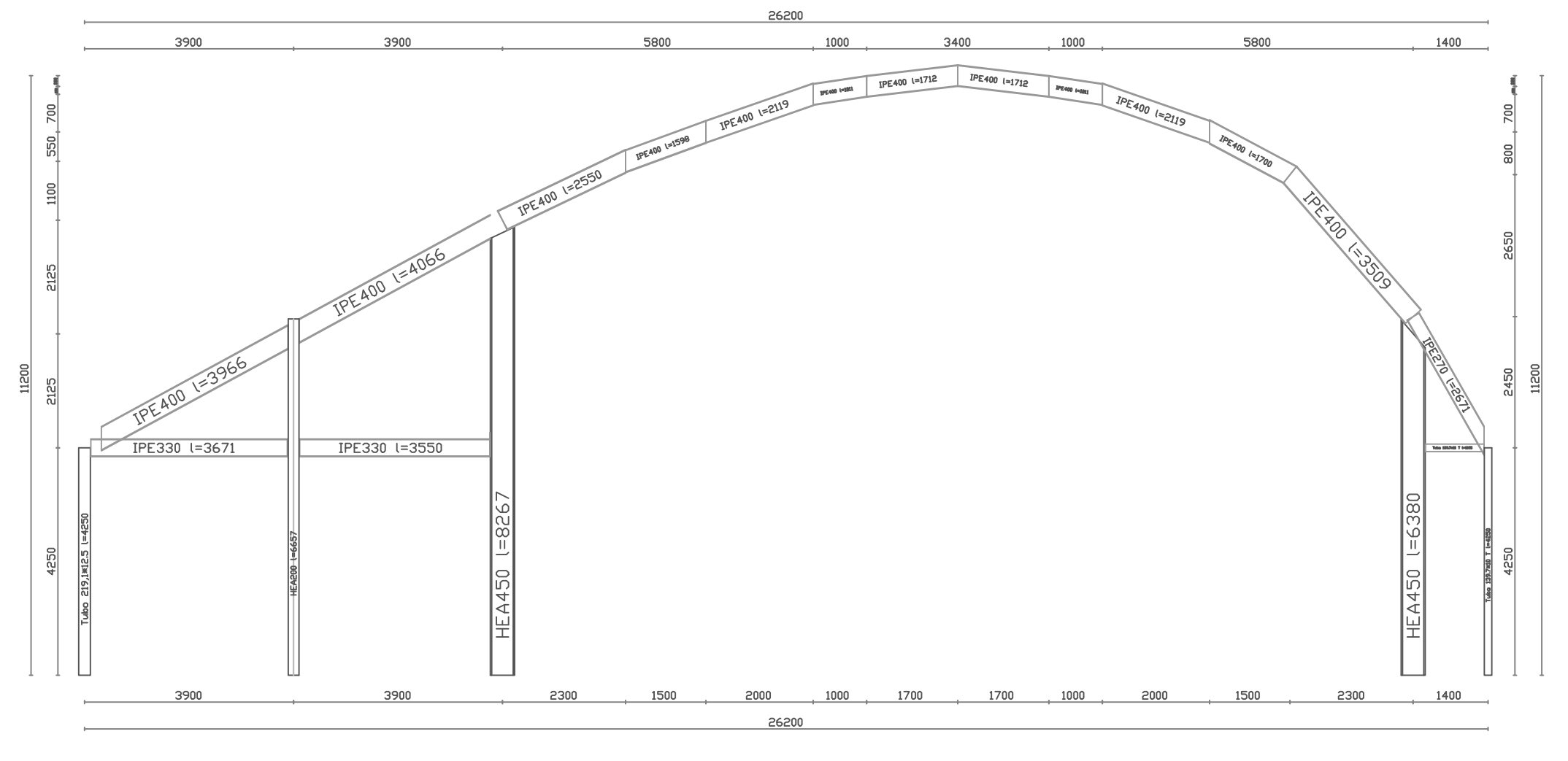
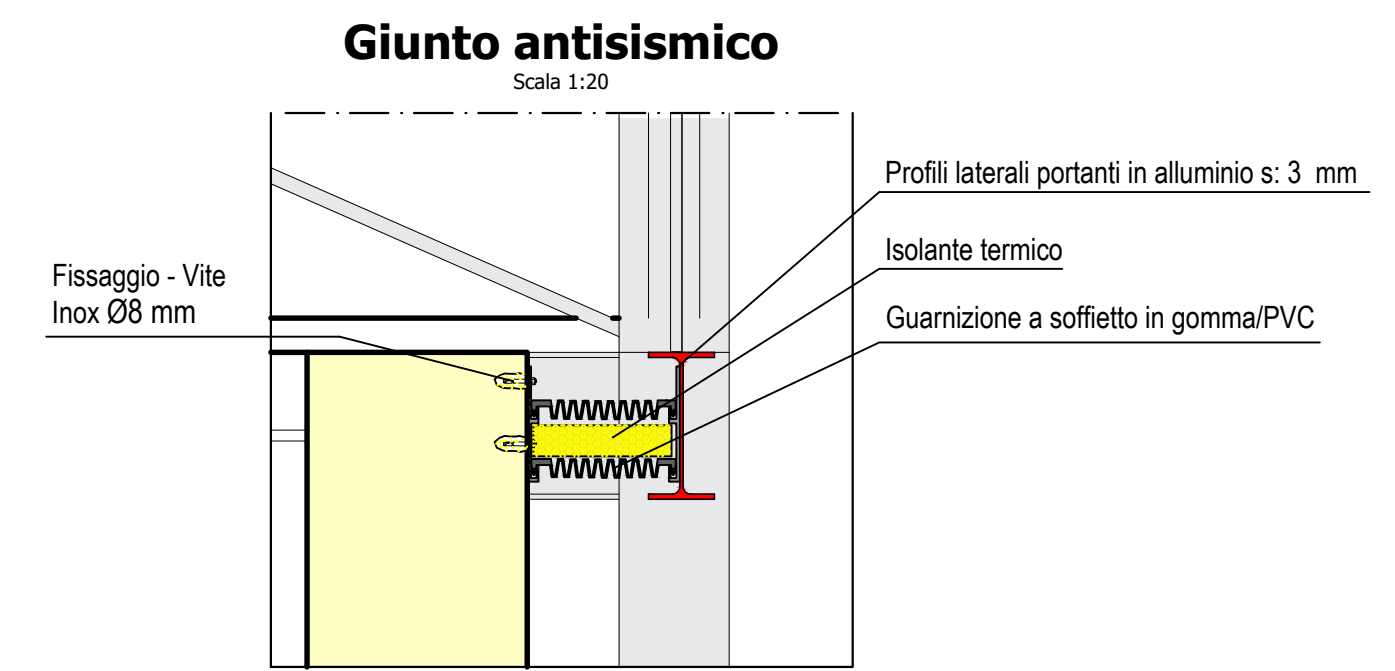
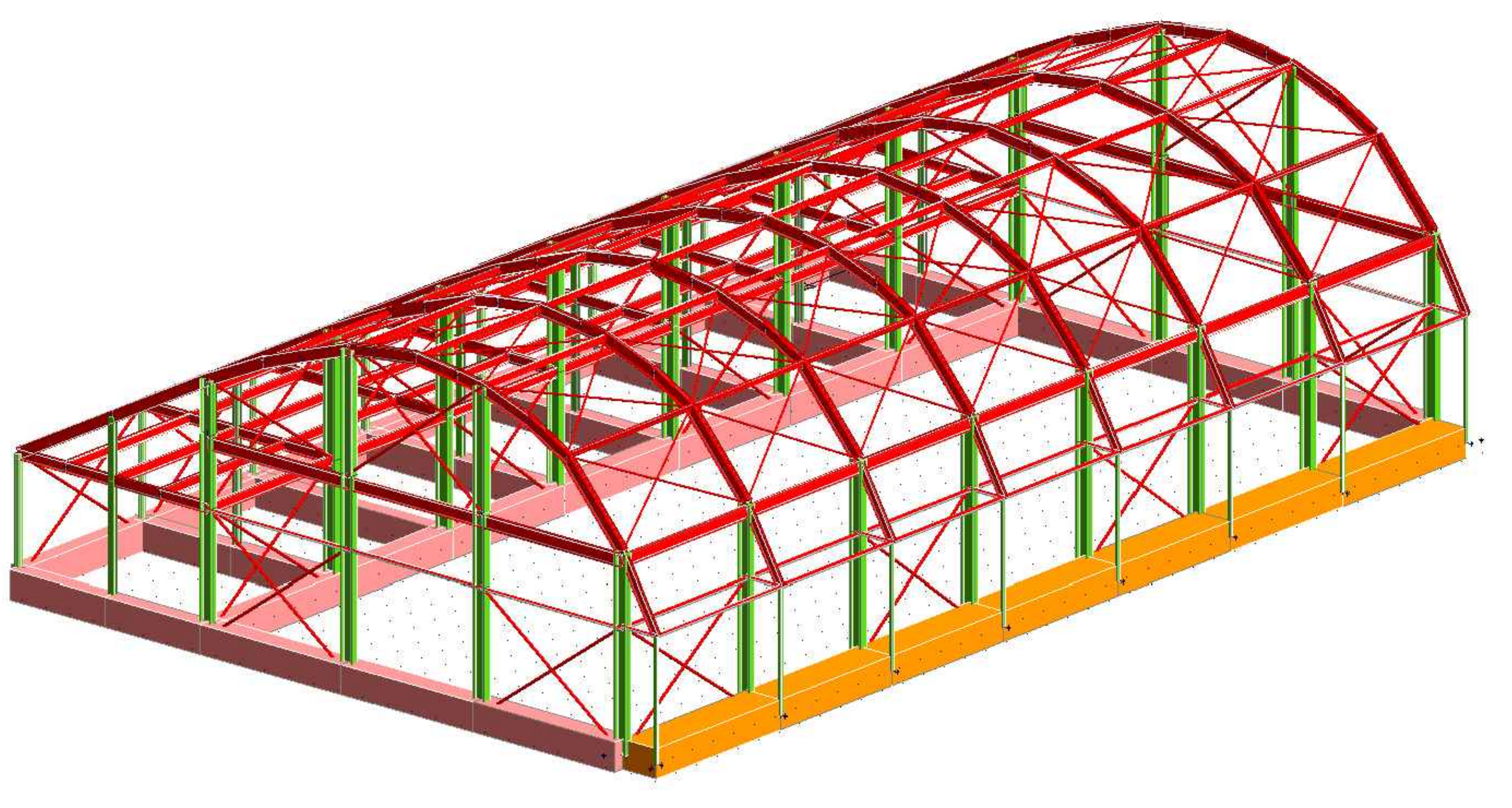
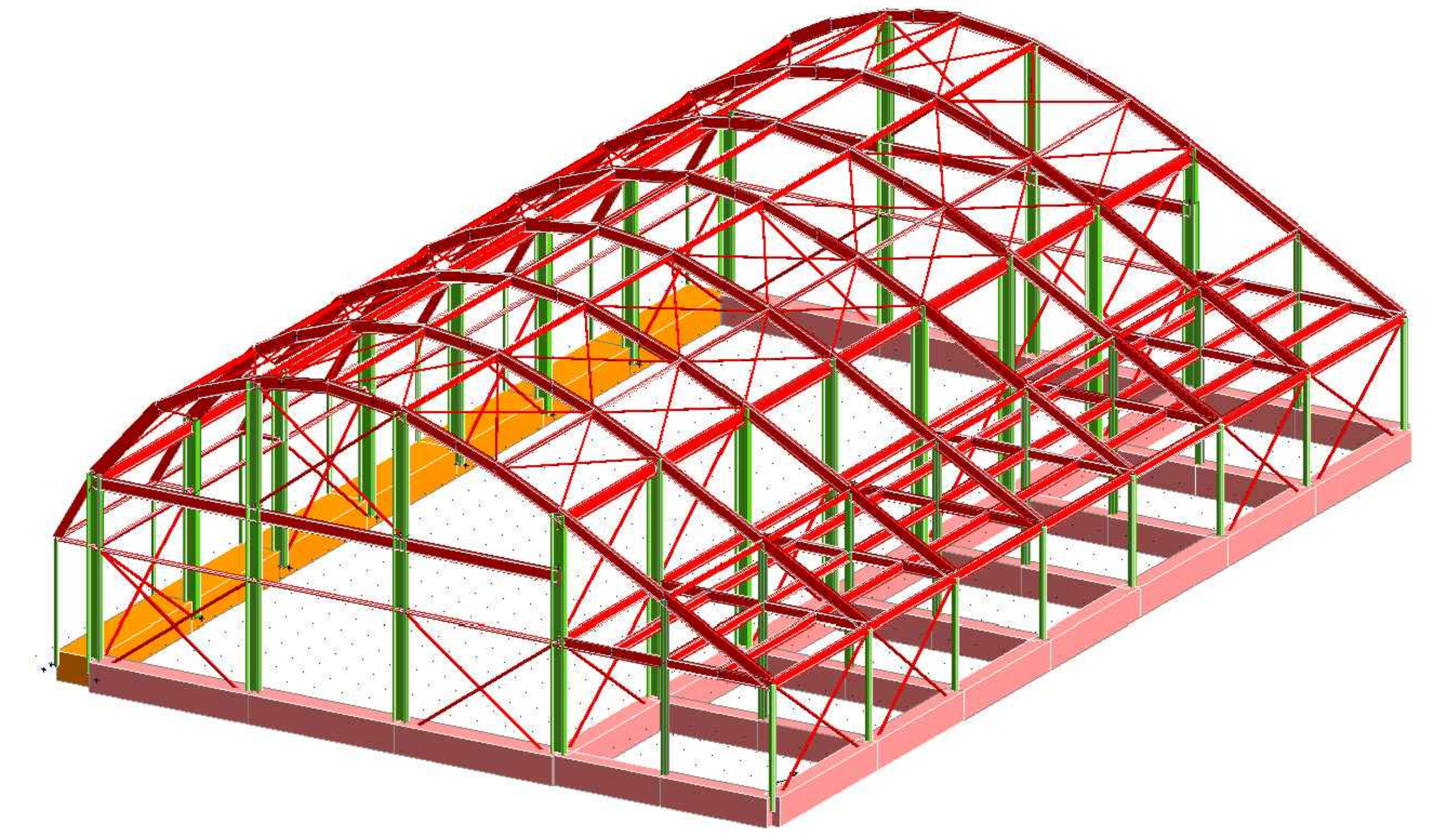

ESECUTIVO TIPO - TELAIO CENTINATURE CENTRALI (N.5)

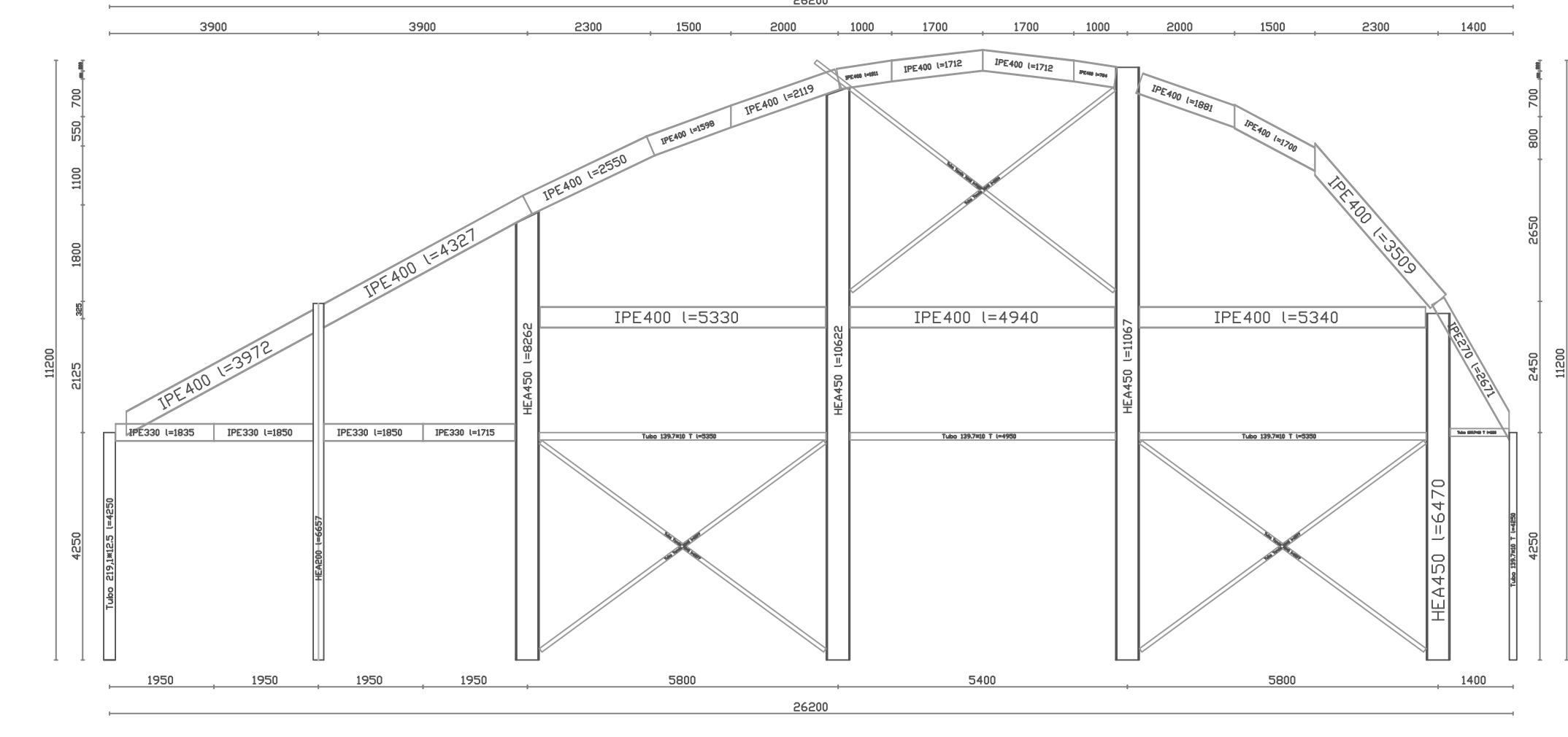

ESECUTIVO TELAIO N.2

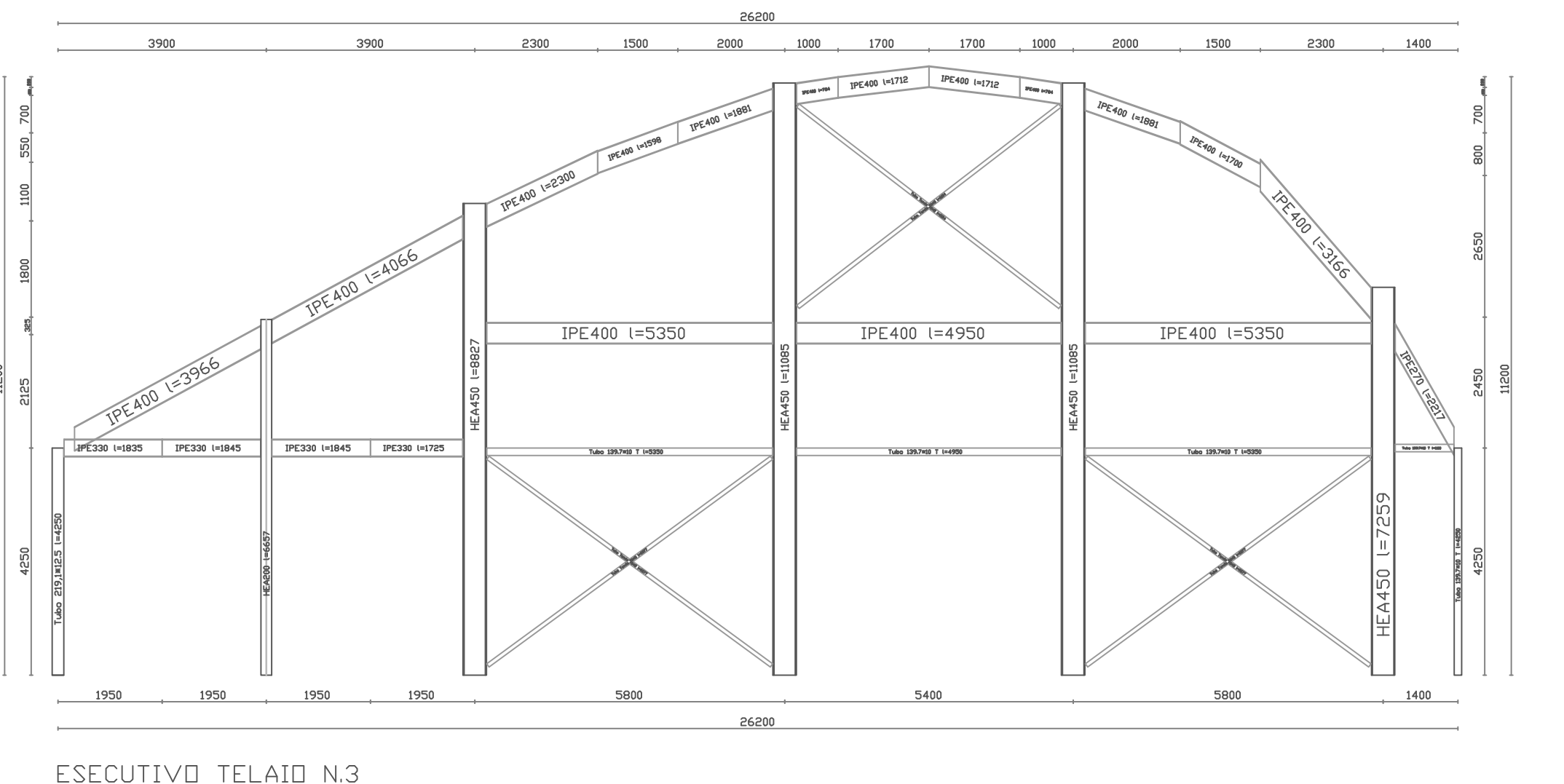

ESECUTIVO TELAIO N.3

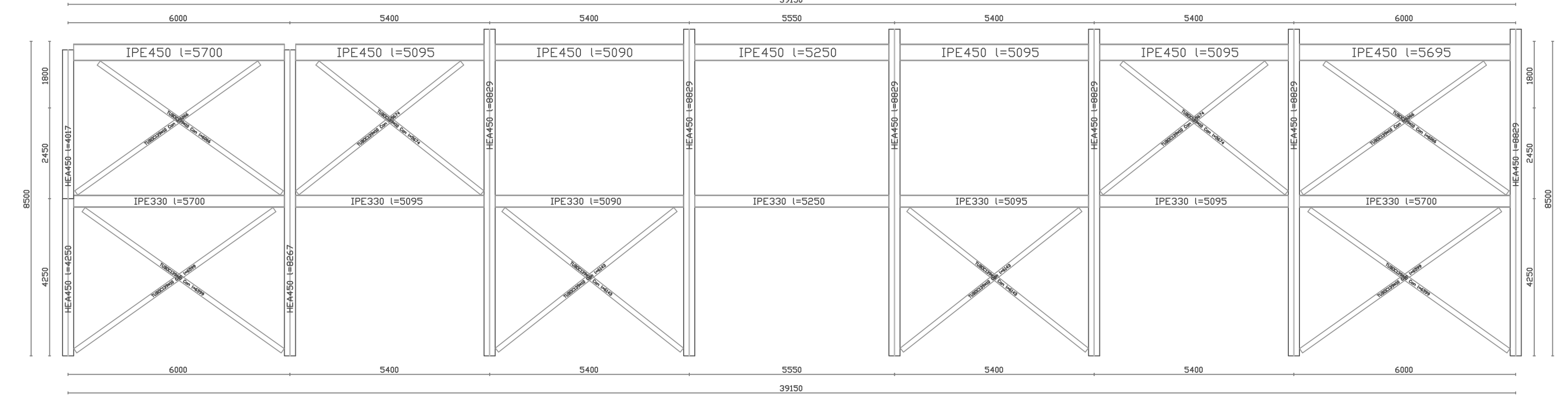

ESECUTIVO TELAIO N.4

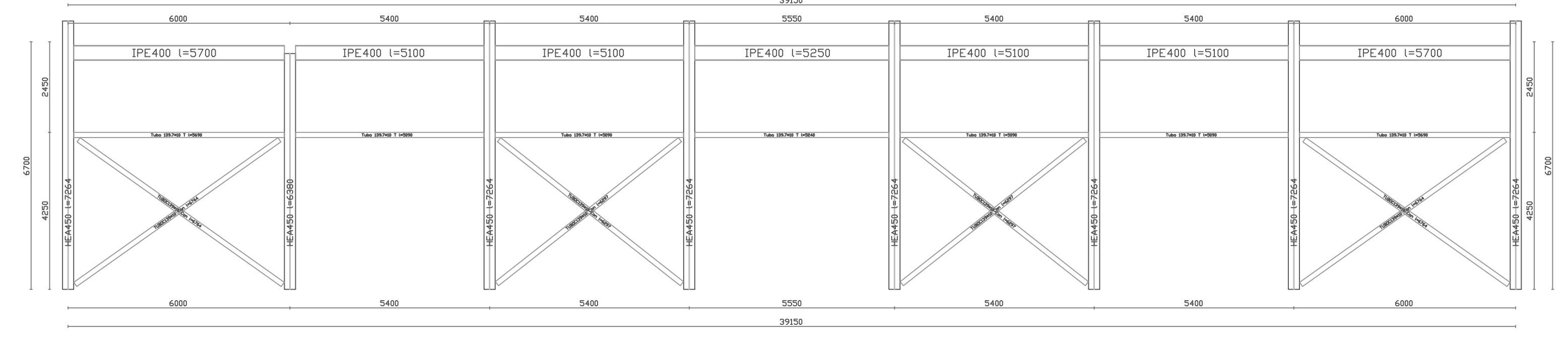

ESECUTIVO TELAIO N.1

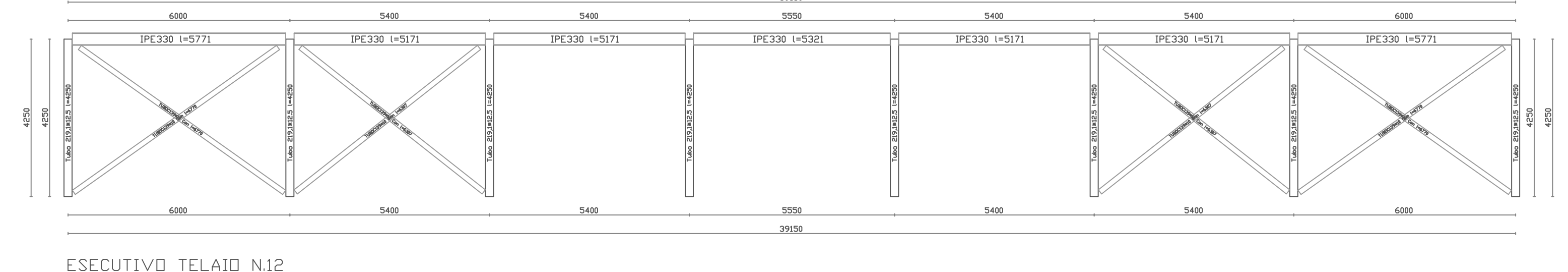

ESECUTIVO TELAIO N.12

Comune di Sant'Arsenio
Provincia di Salerno

OGGETTO: **Intervento di adeguamento sismico della palestra comunale polivalente di via Florenzano**

COMMITTENTE: Comune di Sant'Arsenio

RUP: Arch. Vincenzo Capasso

PROGETTISTA: Arch. Arsenio Carimando

TAVOLA **D7** ELABORATO **PROGETTO STRUTTURALE Interventi su impalcati**

scopio protocollo revisione data

Tel: _____
e-mail: _____

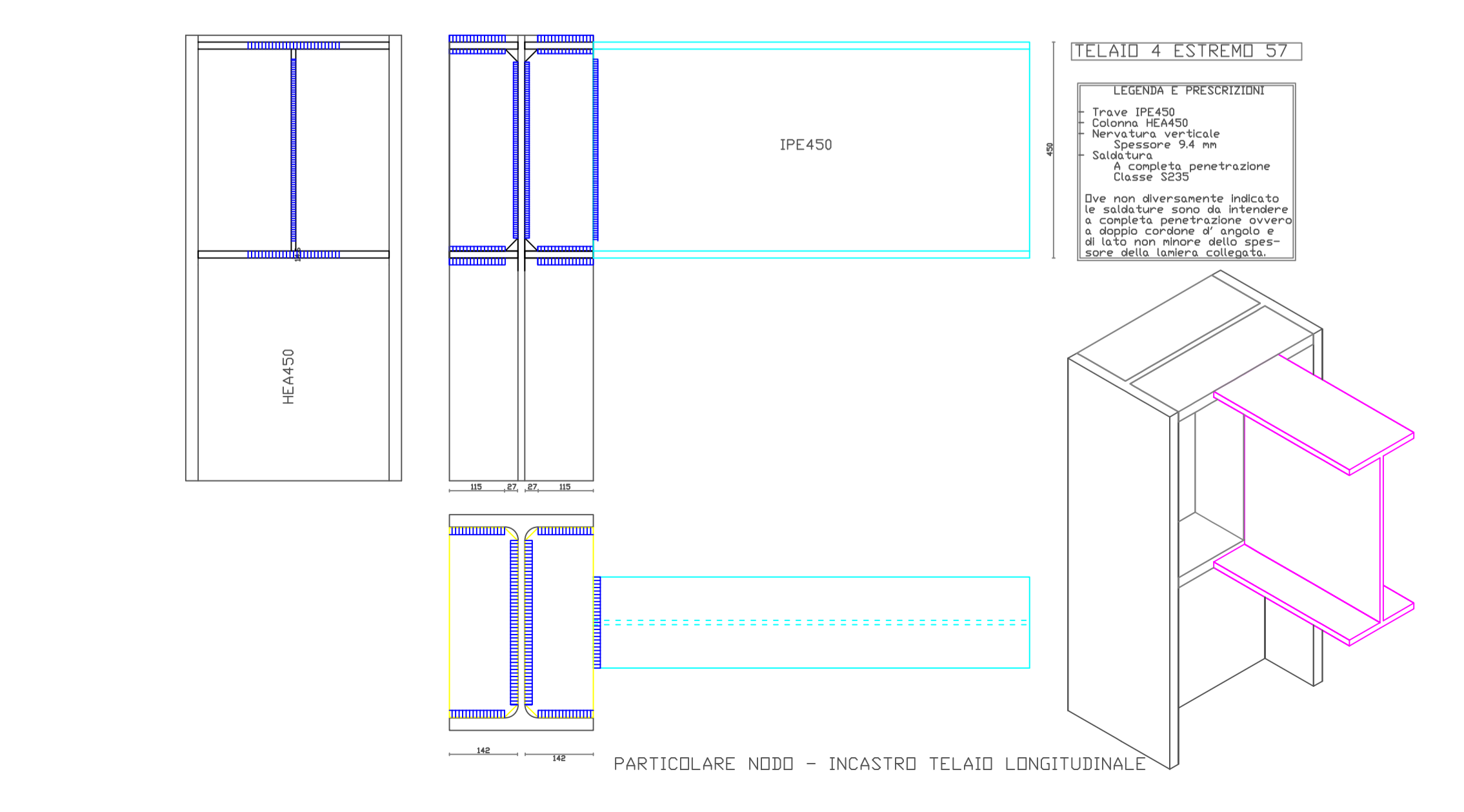
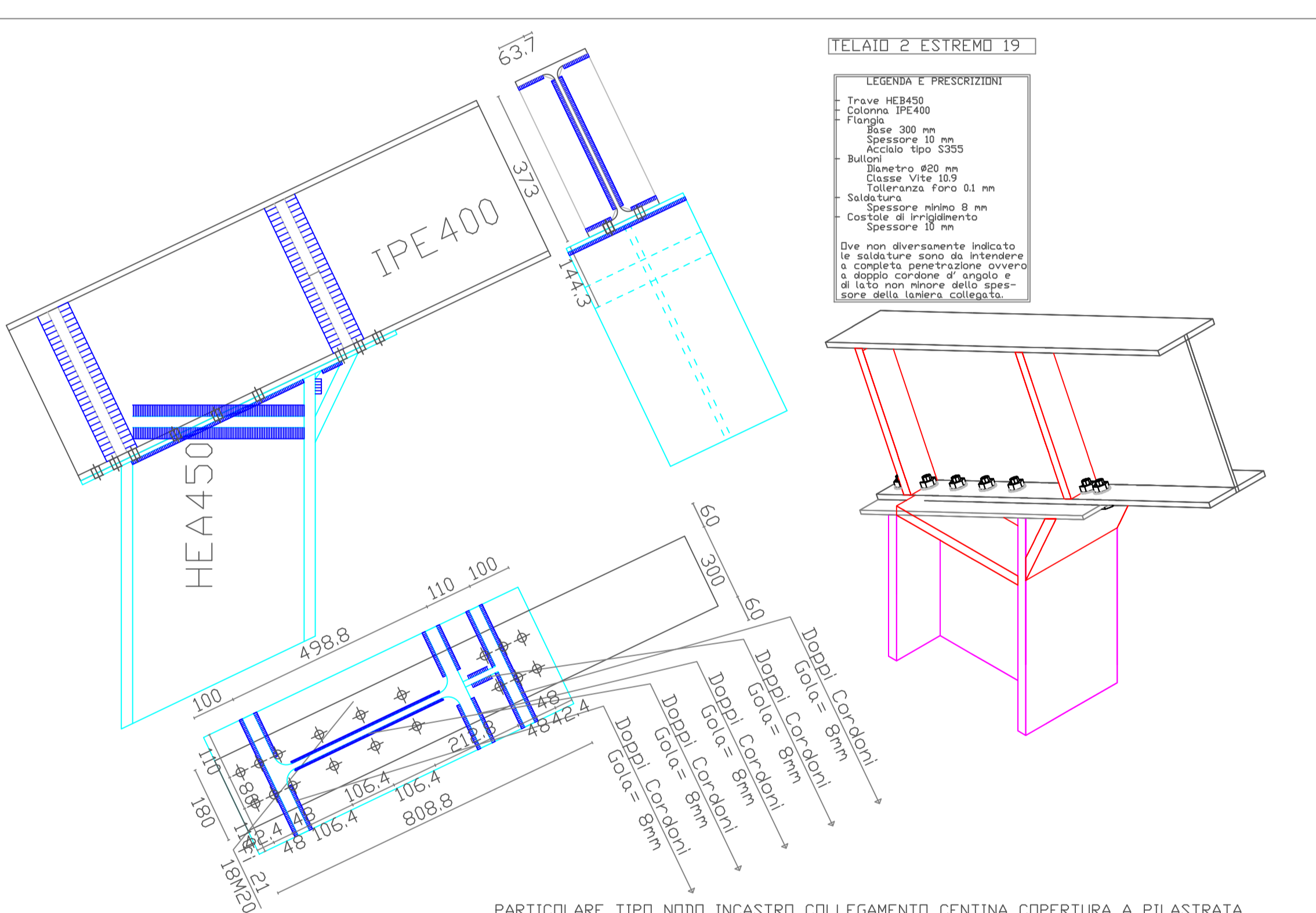
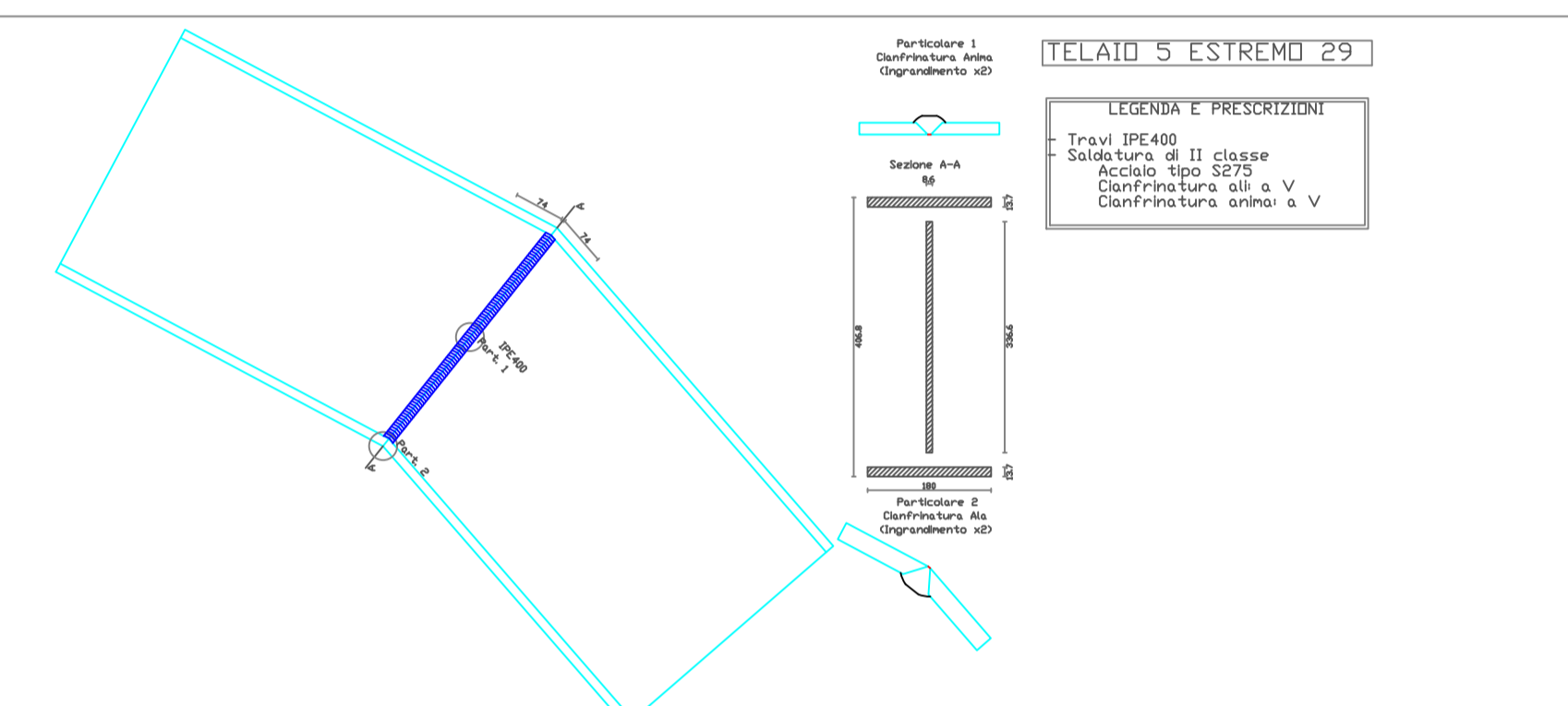
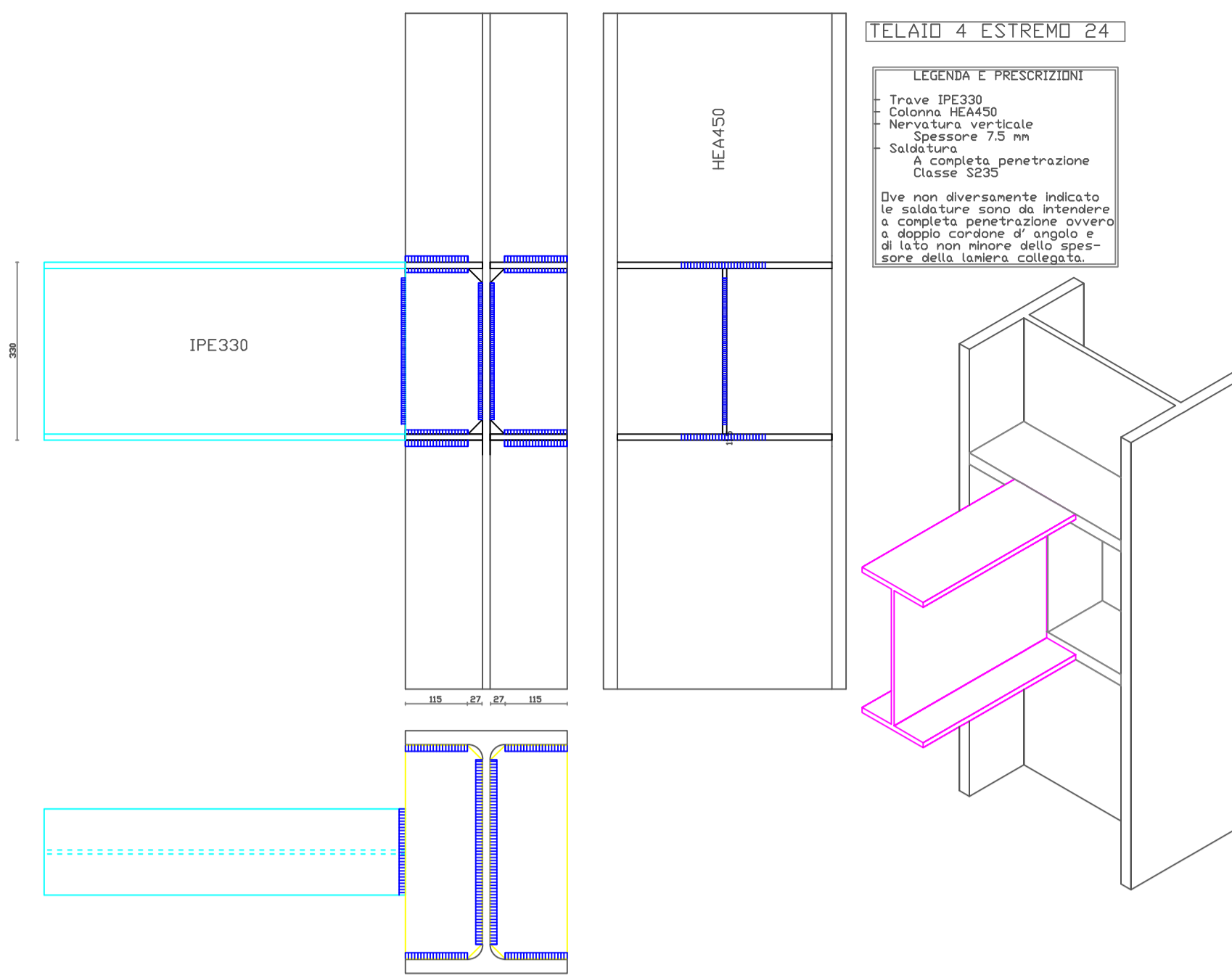
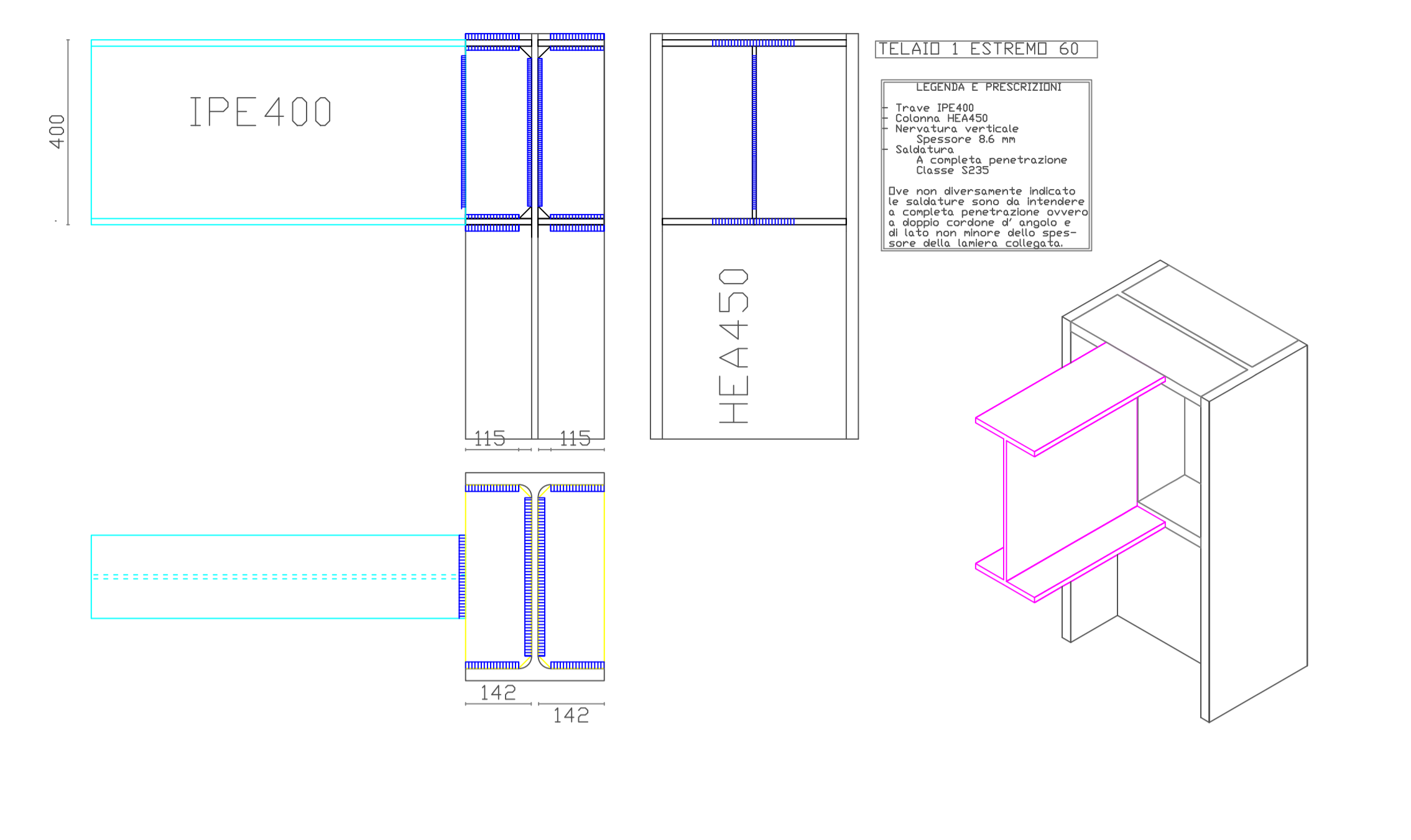
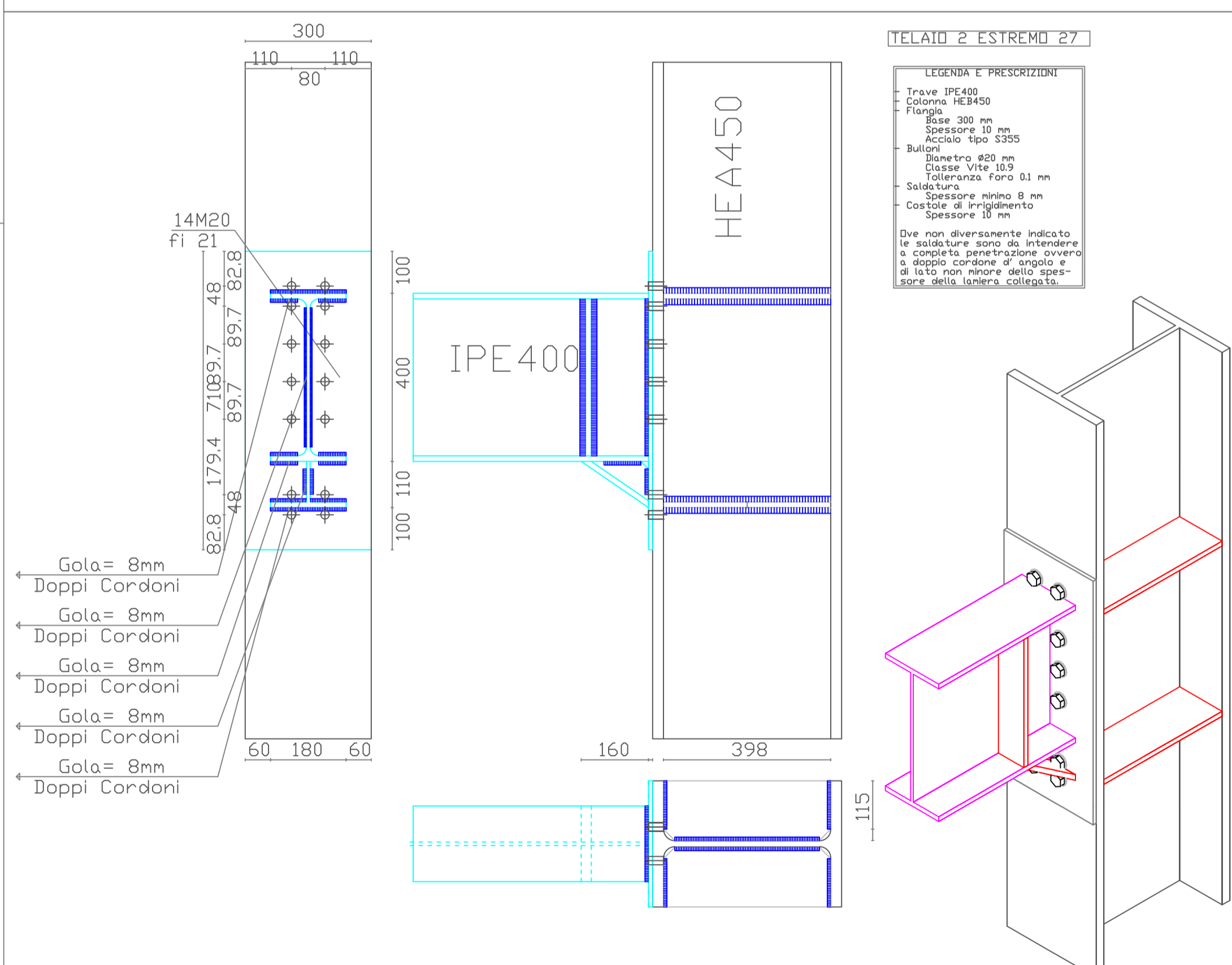
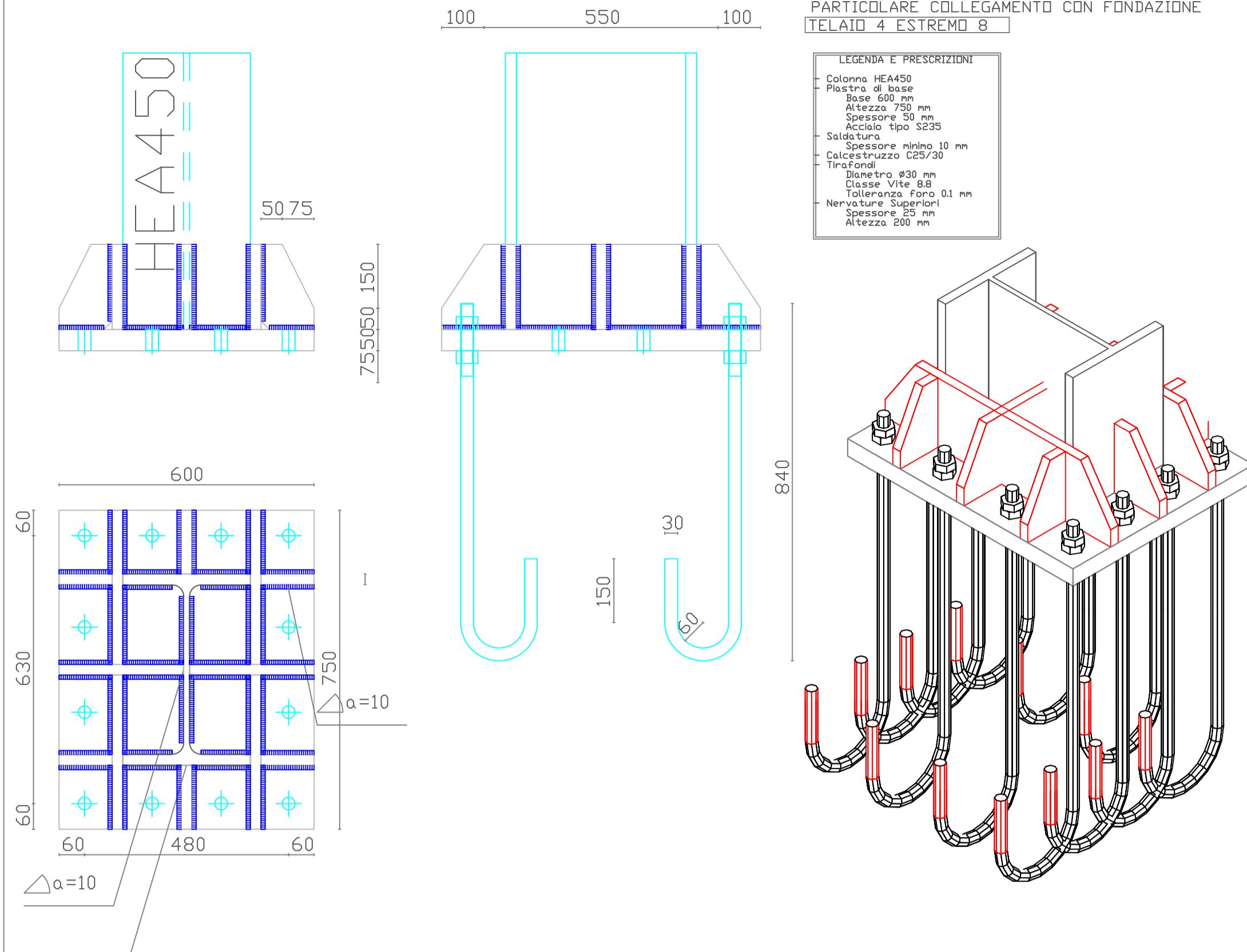
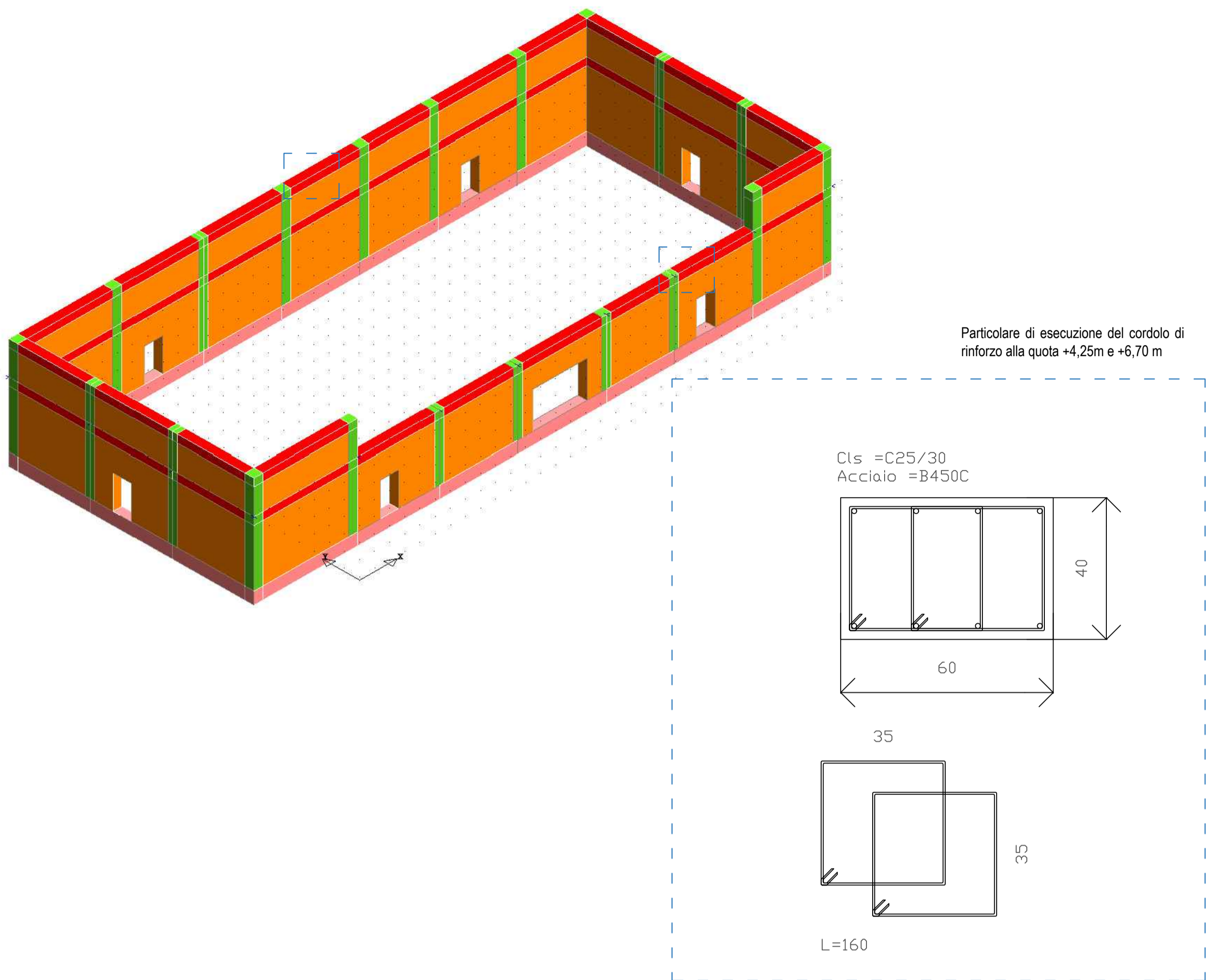

PARTICOLARE NODO COLLEGAMENTO TRAVI ACCIAIO E LEGNO COPERTURA

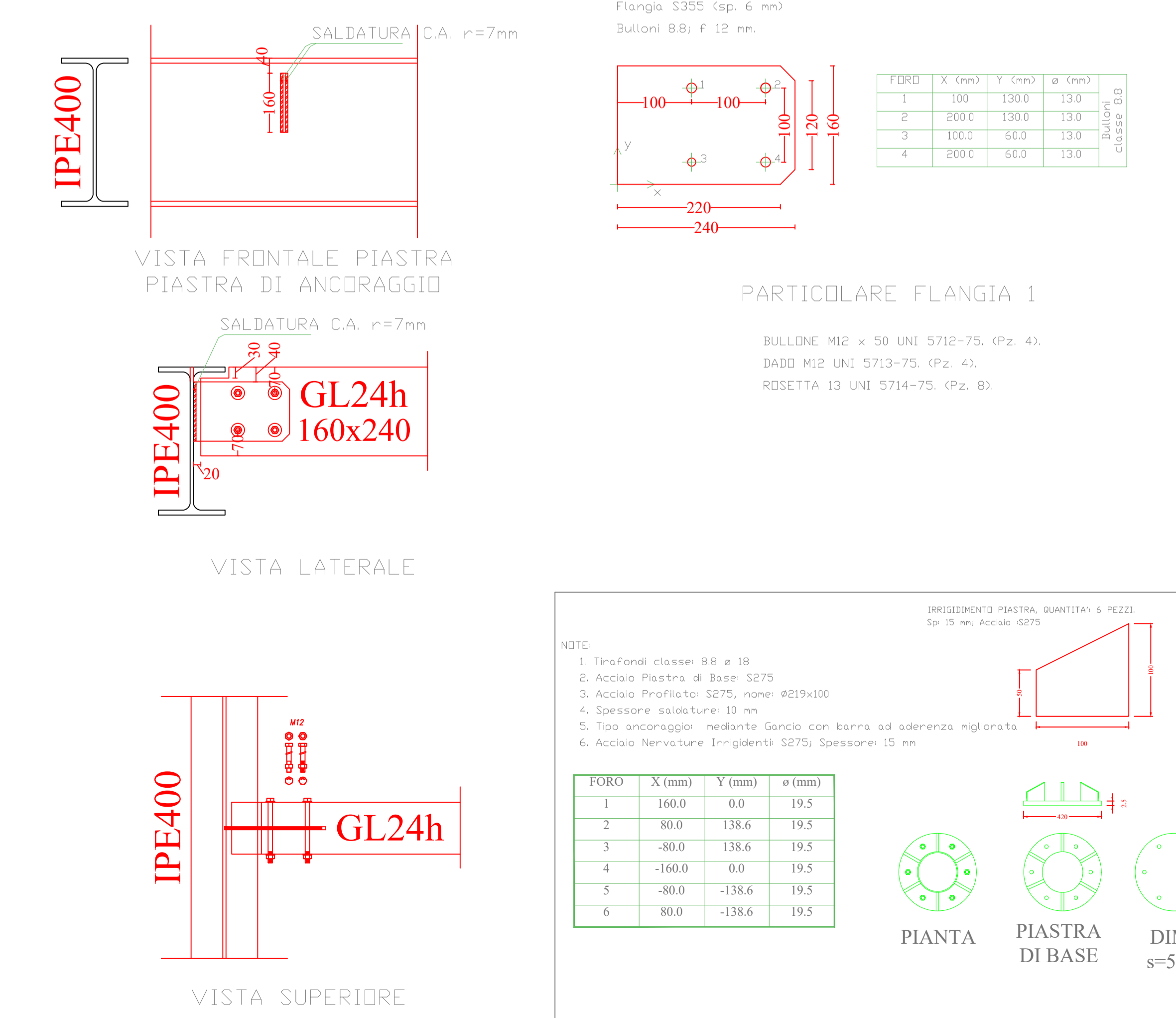

Comune di Sant'Arsenio
Provincia di Salerno

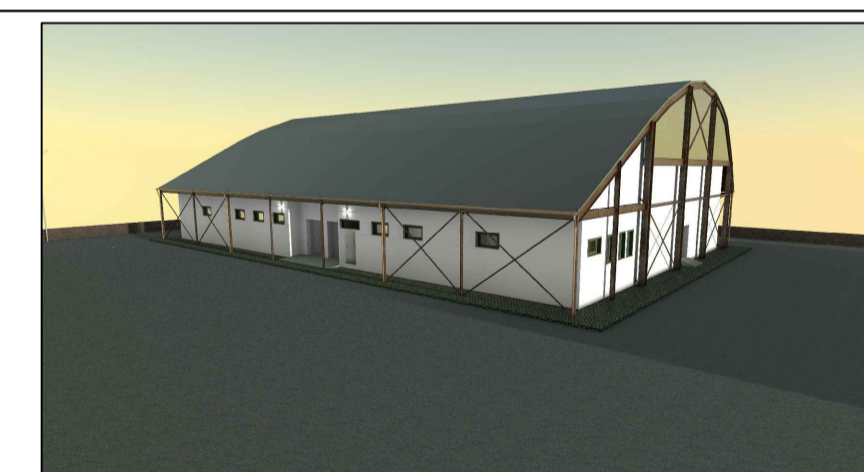

OGGETTO: **Intervento di adeguamento del rischio sismico della palestra comunale di via Florenzano**

COMMITTENTE: **Comune di Sant'Arsenio**

RUP: **Arch. Vincenzo Capasso**

PROGETTISTA: **Arch. Arsenio Carimando**

TAVOLA: **D9**

ELABORATO: **PROGETTO STRUTTURALE Particolari intervento di adeguamento sismico**

scala: protocollo revisione data